

USER MANUAL

[DIGITAL DOOR LOCK]



ES-7000K

PIN NUMBER
RFID CARD
MECHANICAL KEY

The default pin number is 1234.
Please change to new pin number
Ensure not to use consecutive or
repetitive numbers for your safety



info@epic.co.kr www.epic.co.kr

This product should be installed by skilled installer only.
To receive full coverage of the product warranty,
Please do not install by yourself, For safety purposes.

Product Description

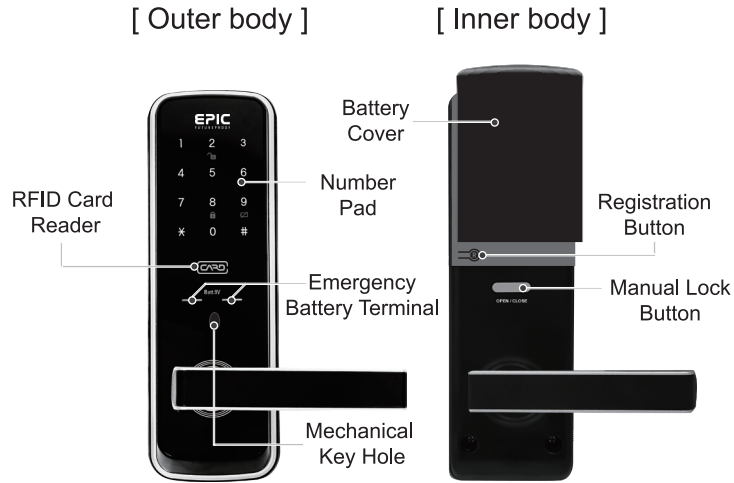

Product Components

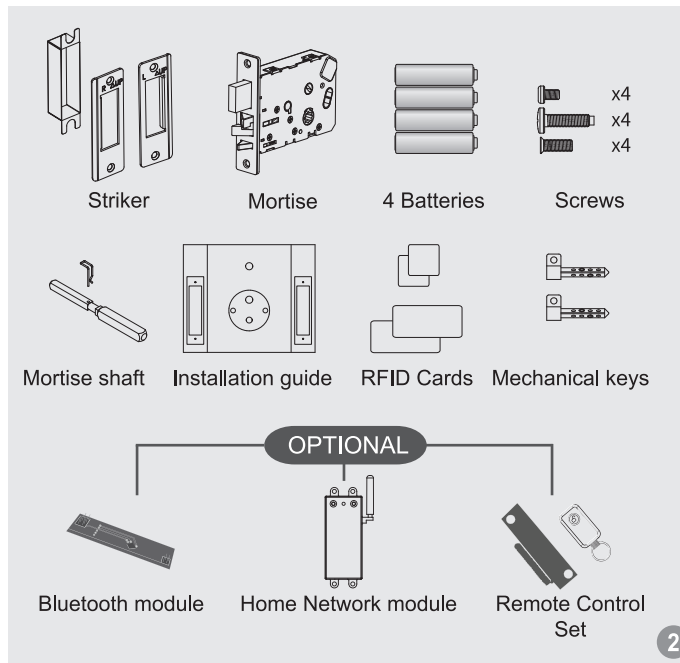

Product Dimension

Description	Specification
Door Thickness	40~50mm
RFID Card	Up to 200 RFID cards can be registered
Power Use	DC 6V (4 LR6 1.5V AA Alkaline battery)
Emergency Power	DC 9V Alkaline battery (not included)
Fire detection temperature	60°C ± 10°C
Material	Al, ABS

User Pin number registration

Caution Please perform while door is open. Default pin number is 1,2,3,4.
Don't forget your pin number. If you forgot your pin number,
New registration of pin number, RFID card is not possible

- Open battery cover, press [Registration] button and beep sound will be heard
- Enter pin number followed by [#] button
(1st Registration : Enter Initial pin number + [#] button)
- Check if the numbers [1, 2, 4, 5] has been lighted on the number pad Press [1] button
- Enter 4~12 digits new pin number to be registered Press [#] button
- Re-Enter new pin number and press [Registration] button

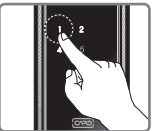

Note

- Only 1 user pin number can be saved
- When error occur during registration process, [2] button will be blinking along with an error sound
- During each process, when [Reg] button is pressed, the registration process will be end
- When the registration process has completed, a completion sound will be heard

User RFID Card Registration (all-at-once)

- Open battery cover, press [Registration] button and beep sound will be heard
- Enter pin number followed by [#] button
- Check if the numbers [1, 2, 4, 5] has been lighted on the number pad Press [2] button
- Place the card to be registered on the card reader. When the card has been successfully registered, The designated 3 digit card number location will be displayed on the number pad
- The numeric LED lights up once in the order of [2] [1,3] [4,6] [7,9] [8] it is now on additional card registration status. If you want to add more cards, repeat steps ④ ~ ⑤. If you no longer have a card to register, press the [Registration] button



User RFID Card Registration (one-by-one)

- Open battery cover, press [Registration] button and beep sound will be heard
- Enter pin number followed by [#] button
- Check if the numbers [1, 2, 4, 5] has been lighted on the number pad Press [2] button
- First select card location number from 001~200 enter on the number pad, press [#] button. When selected number is already in use, error sound will be heard and LED [7] will be lighted on the screen
- The numbers [2] [1,3] [4,6] [7,9] [8] will be lighted in sequence repeatedly, it is in RFID card entry standby status. Place the card to be registerd on the card reader. The beep sound will be heard and the saved 3 digit location number will be displayed on the number pad. To register additional card, repeat steps ④ ~ ⑤. When all cards are registered press [Registration] button to complete



Note

- Up to 200 cards can be registered
- New registration will not delete previously registered card in the system
- When error occur during registration LED [2] will be lighted

User Guest Pin Number Registration (1-time usage)

- Open battery cover, press [Registration] button and beep sound will be heard
- Enter pin number followed by [#] button
- Check if the numbers [1, 2, 4, 5] has been lighted on the number pad Press [4] button
- When LED is all lighted, enter guest pin number to be registered Enter 4~12 digits number and press [#] button
- Enter guest pin number again Press [Registration] button and the registration of guest pin number is complete



Note

- If you register a new guest pin number, the old one will be deleted
- Only 1 guest pin number can be saved. It will be deleted after 1 usage

User Remote Control Registration (all-at-once)

*If the remote control receiver module is not connected, and number [5] button does not light up, the remote control cannot be registered

- Open battery cover, press [Registration] button and beep sound will be heard
- Enter pin number followed by [#] button
- Check if the numbers [1, 2, 4, 5] has been lighted on the number pad Press [5] button and all LED will be lighted, It is now on stand-by mode for Remote Control Registration
- Press [Open] button of the remote control to be registered. When the remote control is registered successfully, the 3-digit remote control number will be displayed on the screen and registration is complete
- To register additional remote control, repeat step ④
- When registration of all remote control is done, press [Registration] button to complete the process

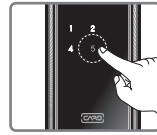

User Remote Control Registration (one-by-one)

*If the remote control receiver module is not connected, and number [5] button does not light up, the remote control cannot be registered

- Open battery cover, press [Registration] button and beep sound will be heard
- Enter pin number followed by [#] button
- Check if the numbers [1, 2, 4, 5] has been lighted on the number pad, press [5] button and all LED will be lighted, It is now on stand-by mode for Remote Control Registration
- When the LED is all lighted enter the Remote control number on the number pad followed by [#] button. You can select from 01~10 Remote Control numbers
- While on stand-by mode for new remote control registration press [Open] button of remote control to be registered
- When the remote control is successfully registered The remote control number will be displayed on the number pad. For registration of additional remote control repeat steps ④ ~ ⑥
- When all remote controls are registered, press [Registration] button to complete registration process

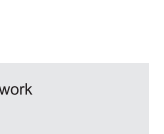
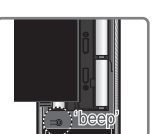

Note

- The network module should be installed on the unit to work
- Up to 10 remote controls can be registered
- New registration will not delete stored ones in the unit
- When an error occur during registration LED [2] will be blinking and an error sound will be heard

User RFID Card Deletion (All-at-once)

- Open battery cover, press [Registration] button for 3 seconds
Number pad will turn on
- Enter user pin number followed by [#] button
User deletion mode on
- Check if numbers [2, 5, 0] are lighted
Press [2] button and the number pad will light up
- When the number pad turns on press [#] button for 5 seconds, the melody will be heard and all cards will be deleted

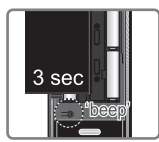

User RFID Card Deletion (one-by-one)

- Open battery cover, press [Registration] button for 3 seconds
Number pad will turn on
- Enter user pin number followed by [#] button
User deletion mode on
- Check if numbers [2, 5, 0] are lighted
Press [2] button and the number pad will light up
- Please enter 3 digit card number(001~200) to be deleted
Press [#] button and the card will be deleted.
To delete additional card, repeat step ④
Press [Registration] button to finish the process

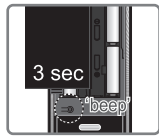

7

User Remote Control Deletion (All-at-once)

※ If the remote control receiver module is not connected, and number [5] button does not light up, the remote control cannot be registered

- Open battery cover, press registration button for 3 seconds
Number pad will light up
- Enter user pin number followed by [#] button
User deletion mode on
- Check if numbers [2, 5, 0] are lighted
Press number [5]
- Check if the number pad is lighted
then press [#] for 5 seconds,
when the melody is heard,
all remote control registered
in the unit has been successfully deleted

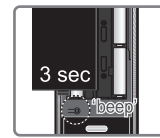

User Remote Control Deletion (one-by-one)

※ If the remote control receiver module is not connected, and number [5] button does not light up, the remote control cannot be registered

- Open battery cover, press [registration] button for 3 seconds
Number pad will light up
- Enter user pin number followed by [#] button
User deletion mode on
- Check if numbers [2, 5, 0] are lighted
Press number [5]
- Enter the remote control number to be deleted,
You can select from 001~010 then press [#] button
and the specific remote control will be deleted
For additional remote control deletion, repeat step ④
To end the registration process,
press [Registration] button

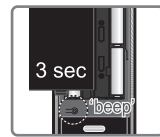

8

Dual-mode security authentication ON / OFF

- After entering the user pin,
press the LED [#] button twice,
Basic Features setting ON
- Press LED [2] button, or press LED [5] button followed by
[Registration] button and setting is complete



Note

- ◆ LED [2] : Dual-mode security authentication ON
- ◆ LED [5] : Dual-mode security authentication OFF
- ◆ The remote control, guest pin number, Bluetooth can open the deadbolt lock without secondary authentication
- ◆ When the secondary authentication(card) of the user is not registered(or all of them are deleted), the deadbolt lock is released only by the user's primary authentication(pin number)
- ◆ If the user's secondary authentication is not registered, dual-mode security authentication can not be turned on and the LED [2] button flashes with an error tone
- ◆ double security authentication is ON and the secondary authentication of the registered user If you delete all, dual-mode security authentication will be OFF

Random Number Feature

- ◆ Up to 20 digits can be entered including the original pin number
- ◆ The Pin number must be entered after the random number

Automatic Card Recognition / Manual Recognition

- Enter the user pin number,
press [#] once basic feature setting ON
- Press [1] button or [4] button
Press [Registration] button and setting is complete



Note

- ◆ [1] : Automatic Mode
- ◆ [4] : Manual Mode
- ◆ In Automatic mode - Place the RFID Card on the card reader and the door will open
- ◆ In Manual mode - Touch the number pad,
Place the RFID Card on the card reader and the door will open

9

Deadbolt auto lock / manual lock

※ An optional feature that lets you set the lock in automatic and manual lock mode

- Enter the user pin number,
press [#] once basic function setting ON
- Press LED [2] button or LED [5] button
Press [Registration] button setting is complete



Note

- ◆ LED [2] : Automatic Mode
- ◆ LED [5] : Manual Mode
- ◆ When deadbolt auto lock is set,
the operation is executed automatically according to the state of the sensor
- ◆ When deadbolt is set to manual, Touch the number pad to execute the lock action

Sound Setting (Buzzer, Voice, Notification, Volume)

- After entering user pin number, press LED [#] button once
to enter basic function setting mode
- Press the LED [3] button or the LED [6] button
- Press the [Registration] button to complete
the setting and exit the setting mode



Note

- ◆ LED [3] : increase volume
- ◆ LED [6] : decrease volume
- ◆ Controls all volume except [Alarm Volume] and [Door Opening Melody Volume]
- ◆ Volume can be set to 8 levels (1 level : silent ~ 8 level : 80dB)

Door Opening Notification ON / OFF

- After entering user pin number,
press [#] button once to enter basic function setting mode
- Press LED [7] button followed by [Registration] button to
complete the setting and exit the setting mode



Note

- ◆ ON and OFF setting is set by pressing alternately
- ◆ When ON is set, [deadbolt auto lock setting] is in progress
and the latched has reacted at least once, When the dead bolt is open,
the buzzer will be heard for 3 times every 7 seconds

10

Voice mode / Buzzer mode setting

- After entering user pin number, press [#] button
once to enter basic function setting mode
- Press [8] button followed by [Registration] button
to complete the setting and exit the setting mode



Note

- ◆ Repeat process to toggle between Voice mode / Buzzer mode setting
- ◆ For models without voice mode, it is always set to buzzer mode

1 minute lock warning function

- ◆ 5 consecutive failed pin number, card,
will result to 1minute suspension of authentication
- ◆ After the alarm sounds for 7 seconds, operation stops for 1 minute
- ◆ During 1 minute lock operation,
an error sound occurs when authentication is attempted
- ◆ During 1 minute lock operation,
Card and Remote control operation will not work
- ◆ Pressing [Open / Close] button will cancel the alarm
- ◆ The alarm can be released with the internal handle

Etiquette setting

- Press [#] button

Note

- ◆ Only the one time, pin, card, authentication will be silent regardless
of [buzzer & alert & notification volume setting]
- ◆ In the case of pin authentication, there is a maximum of 5 correct re-entry chance
- ◆ However, a warning sound will occur after 5 successive authentication failures

Low battery warning function

- ◆ When low battery is detected, the [Battery Replacement] LED lights up
- ◆ When low battery is detected, a notification melody will be heard
- ◆ Low voltage : 4.5V
- ◆ When the voltage returns to 5.5V, the alarm is released

11

User Registration Reset

- Open battery cover,
press registration button for 3 seconds
Number pad will light up
- Enter user pin number followed by [#] button
User deletion mode on
- Check if numbers [2, 5, 0] are lighted
Press [0] button and the number pad will light off
- Press [Open / Close] button inside
- Press [Registration] button for 10 seconds
and all registered information will be deleted in the unit

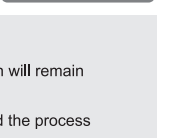
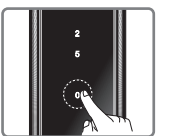
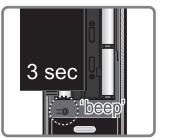

Note

- ◆ Even if the registration reset is performed the initial administrator pin will remain
- ◆ Only registered items will be deleted. Settings will remain
- ◆ Pressing [Reg] button while performing each ③ ~ ④ steps will end the process

Self-diagnosis

- ◆ LED [2] : Registration & Deletion error
(pin, card, remote control, dual-mode security authentication ON Setting failed)
- ◆ LED [3] : Registration error
(pin, card, number of remote control registration full)
- ◆ LED [4] : Deadbolt operation error
- ◆ LED [5] : Intrusion alarm
- ◆ LED [6] : Authentication error (unregistered pin, card)
- ◆ LED [7] : In the registration mode, the number placement already registered
(card, remote control)
- ◆ LED [8] : Fire Alarm
- ◆ LED [9] : Internal / External Force Lock Setting

12